

# 吉生 GISON

## GP-500 Air Hydraulic Riveter

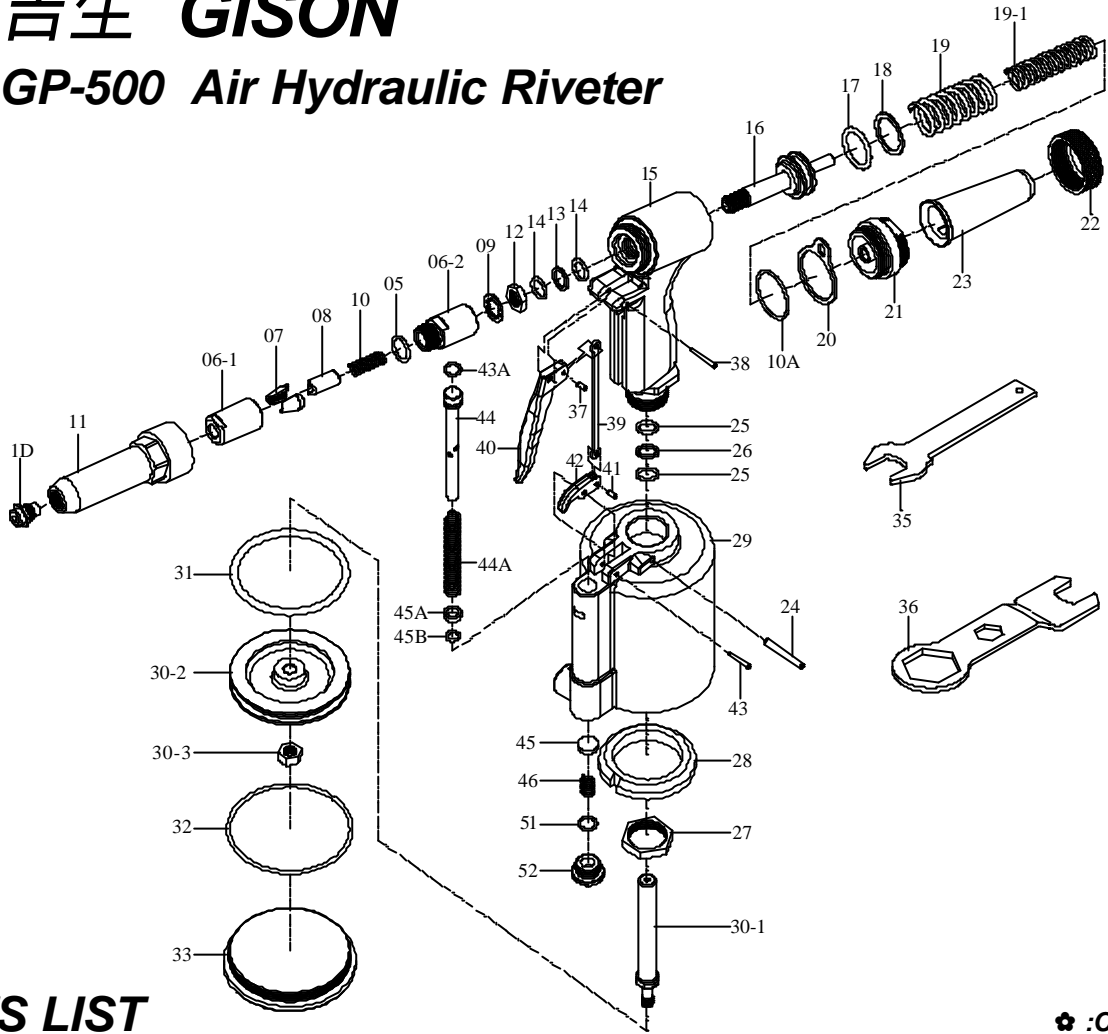

### PARTS LIST

✦ :Consuming Part

No.	Part No.	Description	Qty.	No.	Part No.	Description	Qty.
01	500001	Nosepiece (3/16", 5/32", 1/8", 3/32", 1/4", 7/32")	1	26	500026	Back Up Ring	1
05	500005	Jaw Case End Tart O-Ring	1	27	500027	Frame Lock Nut	1
06-1	500006-1	Jaw Case Front Tart (1/4", 7/32", 3/16")	1	28	500028	Rubber Cushion	1
06-2	500006-2	Jaw Case End Tart	1	29	500029	Air Cylinder	1
06-1A	500006-1A	Jaw Case Front Tart (3/32", 1/8", 5/32")	1	30-1	500030-1	Air Piston Stem	1
07	500007	Jaw Old	1	30-2	500030-2	Air Piston	1
07A	500007A	Jaw Small	1	30-3	500030-3	Air Piston Lock Nut	1
08	500008	Jaw Pusher (1/4", 7/32", 3/16")	1	31	500031	Air Piston O-Ring	1
08A	500008A	Jaw Pusher (3/32", 1/8", 5/32")	1	32	500032	Cylinder	1
09	500009	Case Washer Ring	1	33	500033	Cylinder Cap	1
10	500010	Jaw Pusher Spring (1/4")	1	35	500035	Spanner Gauge	1
10-1	500010-1	Jaw Pusher Spring (5/32")	1	36	500036	Spanner	1
10-A	500010-A	Frame Cap O-Ring (27x2)	1	37	500037	Trigger Pin (3x6)	1
11	500011	Frame Head	1	38	500038	Connector (3x22)	1
12	500012	Case Lock Nut	1	39	500039	Trigger Rod	1
13	500013	Back Up Ring	1	40	500040	Trigger	1
14	500014	Back Up O-Ring (P12)	2	41	500041	Connector (3x6)	1
15	500015	Frame	1	42	500042	Trigger Lever	1
16	500016	Oil Piston	1	43	500043	Lever Pin (3x18)	1
17	500017	Oil Piston O-Ring (P24)	1	43A	500043A	Valve Pusher O-Ring (P9)	1
18	500018	Back Up Ring	1	44	500044	Valve Pusher	1
19	500019	Return Spring (Large)	1	44A	500044A	Valve Spring	1
19-1	500019-1	Return Spring (Small)	1	45	500045	Valve	1
20	500020	Hanging Clip	1	45A	500045A	Valve Collar	1
21	500021	Frame Cap	1	45B	500045B	Collar O-Ring (P4)	1
22	500022	Frame Cap Nut	1	46	500046	Valve Spring (Bottom)	1
23	500023	Safety Cap	1	47	500047	Inlet Bushing	1
24	500024	Setting Screw Pin (4x34)	1	48	500048	Inlet Bushing Nut	1
25	500025	Back Up O-Ring (P12)	2	51	500051	Valve Cap O-Ring (P10)	1
				52	500052	Valve Cap	1