

# 吉生 GISON

## GP-R45 Air Coil Roofing Nailer

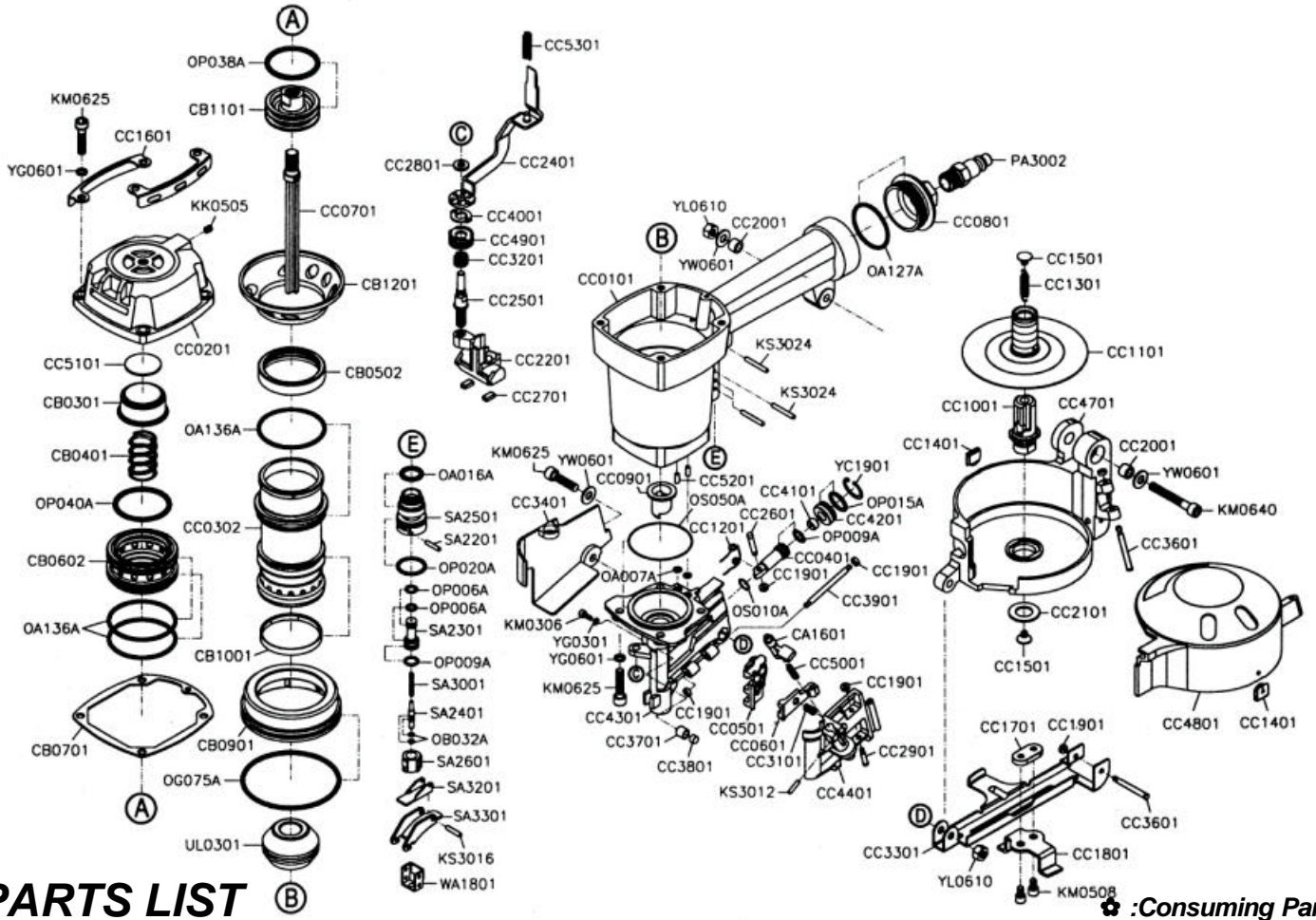

### PARTS LIST

✳ : Consuming Part

Item No.	Part No.	Description	Qty.	Item No.	Part No.	Description	Qty.	Item No.	Part No.	Description	Qty.
1	CA1601	Door Latch	1	33	CC2401	Upper Safety	1	65	KS3016	Spring Pin (Ø3-16L)	1
2	CB0301	Piston Stop	1	34	CC2501	Adjusting Pin	1	66	KS3024	Spring Pin (Ø3-24L)	4
3	CB0401	Compression Spring	1	35	CC2601	Feed Pawl Pin	1	67	OA007A	O-Ring (ARP568-007)	2
4	CB0502	Head Valve Seal	1	36	CC2701	Block	2	68	OA016A	O-Ring (ARP568-016)	1
5	CB0602	Head Valve Piston	1	37	CC2801	Post	1	69	OA127A	O-Ring (ARP568-127)	1
6	CB0701	Cap Seal	1	38	CC2901	Check Pawl Pin	1	70	OA136A	O-Ring (ARP568-136)	3
7	CB0901	Cylinder Ring	1	39	CC3101	Spring	1	71	OB032A	O-Ring (2.5 × 1.4)	2
8	CB1001	Check Seal	1	40	CC3201	Spring	1	72	OG075A	O-Ring (G75)	1
9	CB1101	Main Piston	1	41	CC3301	Gage Bracket	1	73	OP006A	O-Ring (P6)	2
10	CB1201	Collar	1	42	CC3401	Triip Cover	1	74	OP009A	O-Ring (P9)	2
11	CC0101	Body	1	43	CC3601	Pin	2	75	OP015A	O-Ring (P15)	1
12	CC0201	Cylinder Cap	1	44	CC3701	Seat	1	76	OP020A	O-Ring (P20)	1
13	CC0302	Cylinder	1	45	CC3801	Stell	1	77	OP038A	O-Ring (P38)	1
14	CC0401	Feed Piston	1	46	CC3901	Pin	1	78	OP040A	O-Ring (P40)	1
15	CC0501	Feed Pawl	1	47	CC4001	Fixed Seat	1	79	OS010A	O-Ring (S10)	1
16	CC0601	Holding Pawl	1	48	CC4101	Piston Bumper	1	80	OS050A	O-Ring (S50)	1
17	CC0701	Driver	1	49	CC4201	Feed Piston Cap	1	81	PA3002	COUPLING PLUG (¼")	1
18	CC0801	End Cap	1	50	CC4301	Nose	1	82	SA2201	STOP PIN	2
19	CC0901	Driver Guide	1	51	CC4401	Door	1	83	SA2301	PILOT VALVE	1
20	CC1001	Magazine Post	1	52	CC4701	Canister	1	84	SA2401	TRIGGER VALVE STEM	1
21	CC1101	Platform Assy.	1	53	CC4801	Canister Cover	1	85	SA2501	TRIGGER VALVE SEAT	1
22	CC1201	Spring	1	54	CC4901	Adjusting Roll	1	86	SA2601	INNER VALVE SEAT	1
23	CC1301	Spring	1	55	CC5001	Spring	1	87	SA3001	SPRING	1
24	CC1401	Wear Clip	2	56	CC5101	Piston Stop Spacer	1	88	SA3201	CONTACT LEVER	1
25	CC1501	Spring Recelver	2	57	CC5201	Exhaust Roll	1	89	SA3301	TRIGGER	1
26	CC1601	Wear Plate	2	58	CC5301	Sfety Spring	1	90	UL0301	BUMPER	1
27	CC1701	Nut Plate	1	59	KK0505	Set Screw (M5 × 0.8-5L)	1	91	WA1801	SFETY GUIDE	1
28	CC1801	Gage	1	60	KM0306	Hex.Soc.Hd.Bolt (M3 × 0.5-6L)	1	92	YC1901	C-RING (Ø19)	1
29	CC1901	Bushing	6	61	KM0508	Hex.Soc.Hd.Bolt (M5 × 0.8-8L)	2	✳93	YG0301	SPRING WASHER (Ø3)	1
30	CC2001	Bushing	2	62	KM0625	Hex.Soc.Hd.Bolt (M6 × 1.0-25L)	9	94	YG0601	SPRING WASHER (Ø6)	4
31	CC2101	Retainer Post	1	63	KM0640	Hex.Soc.Hd.Bolt (M6 × 1.0-40L)	1	95	YL0610	LOCK NUT (M6 × 1.0)	2
32	CC2201	Trip Foot	1	64	KS3012	Spring Pin (Ø3-12L)	1				